

Liu Pier

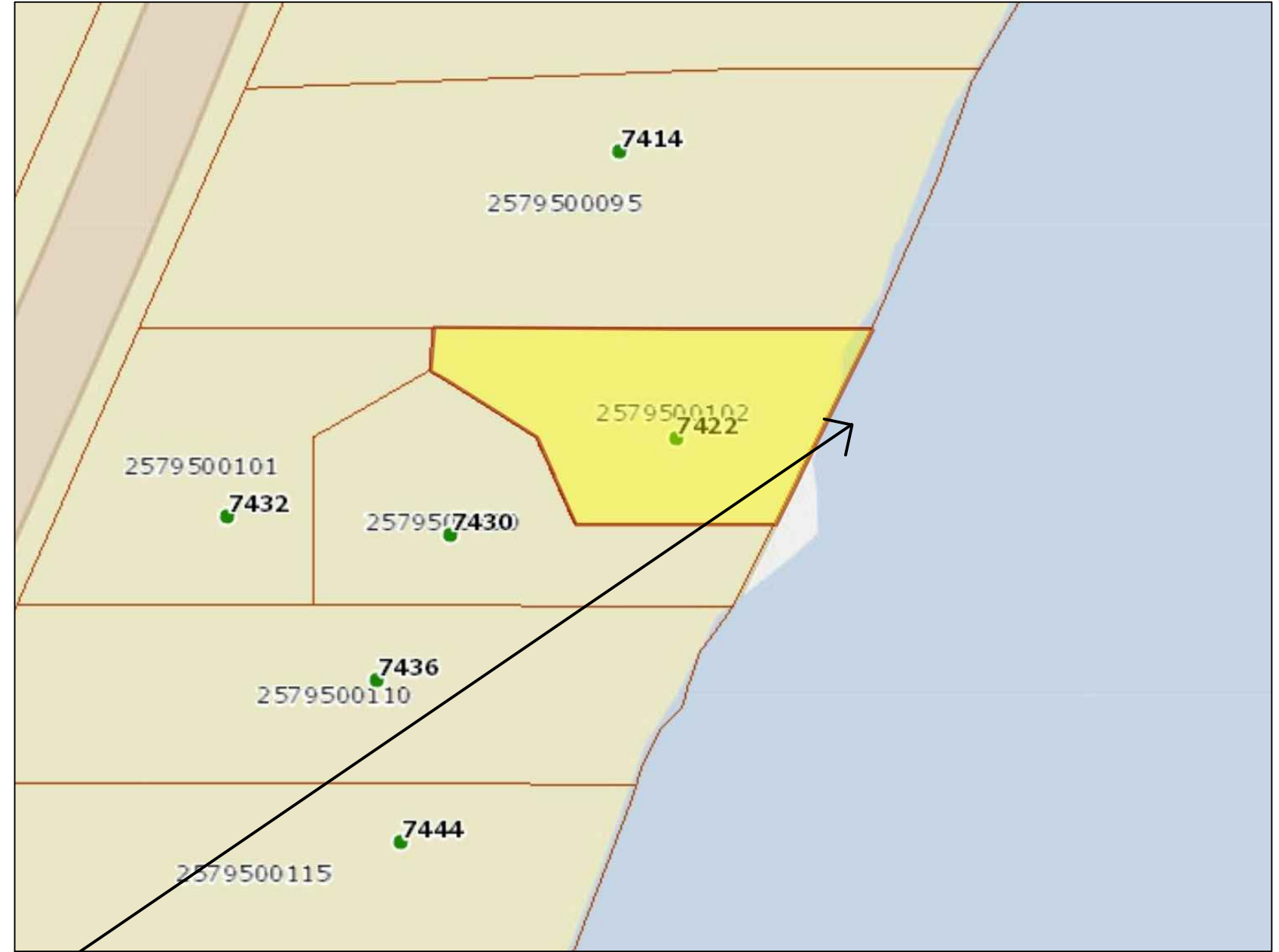
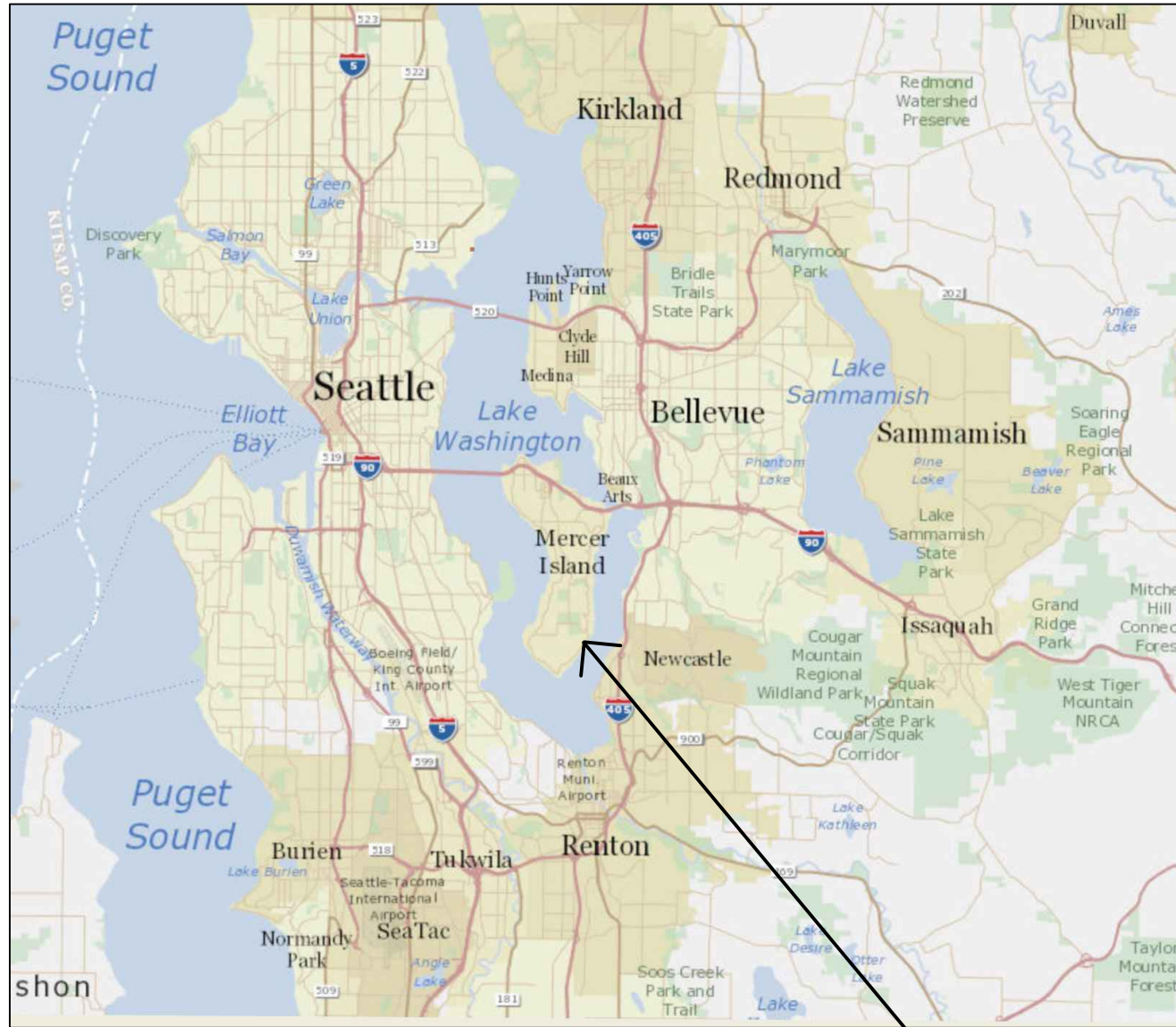

SUBJECT PROPERTY

PIN: 257950-0102

LEGAL DESCRIPTION: FLOODS LAKE SIDE TRS LOT C TGW SH LDS ADJ MERCER ISLAND SHORT PLAT NO 81-6-07 REC #8304079001

SD PLAT DAF - ALL LOT 14 & S 35 FT OF 13

<p>PURPOSE: The proposed repair and extension of the pier is to provide for safe boat moorage for the owner's personal boat.</p>	<p>PREPARED BY:  JACOB BAWDEN OF SEABORN PILE DRIVING 9311 SE 36TH ST, SUITE 204 MERCER ISLAND, WA 98040 OFFICE: 206-236-1700 JACOB@SEABORNPILEDIVING.COM WWW.SEABORNPILEDIVING.COM</p>	<p>PROPOSED: Normal repair to an existing shared pier, consisting of permanently removing 720 sq ft moorage cover, remove the inshore 17' x 6' pier section and (13) associated piles, drive (9) wood piles and reconstruct the 40'x 4' pier entrance and a 15' x 6' finger pier extension</p>
<p>DATUM: CORPS OF ENGINEERS 1919 SW QUARTER OF SECTION 14, TOWNSHIP 25, RANGE 04 ADJACENT OWNERS: OREM JAMES DAVID+MARGARET F ROACHE' JEROME Y+LYNN C TUT Address: 7414 E MERCER WAY 98040 Address: 7430 E MERCER WAY 98040</p>	<p>IN: LAKE WASHINGTON AT: 7422 E. Mercer Way COUNTY: KING 47.5360 N. lat -122.2124 W. Long CREATED: 5/13/2019</p>	<p>APPLICANT: DUSTIN HOWEL SEABORN PILE DRIVING COMPANY 9311 SE 36th ST, SUITE 204 MERCER ISLAND, WA 98040</p>

SHEET A1.0

PROPOSED AND EXISTING CONDITIONS

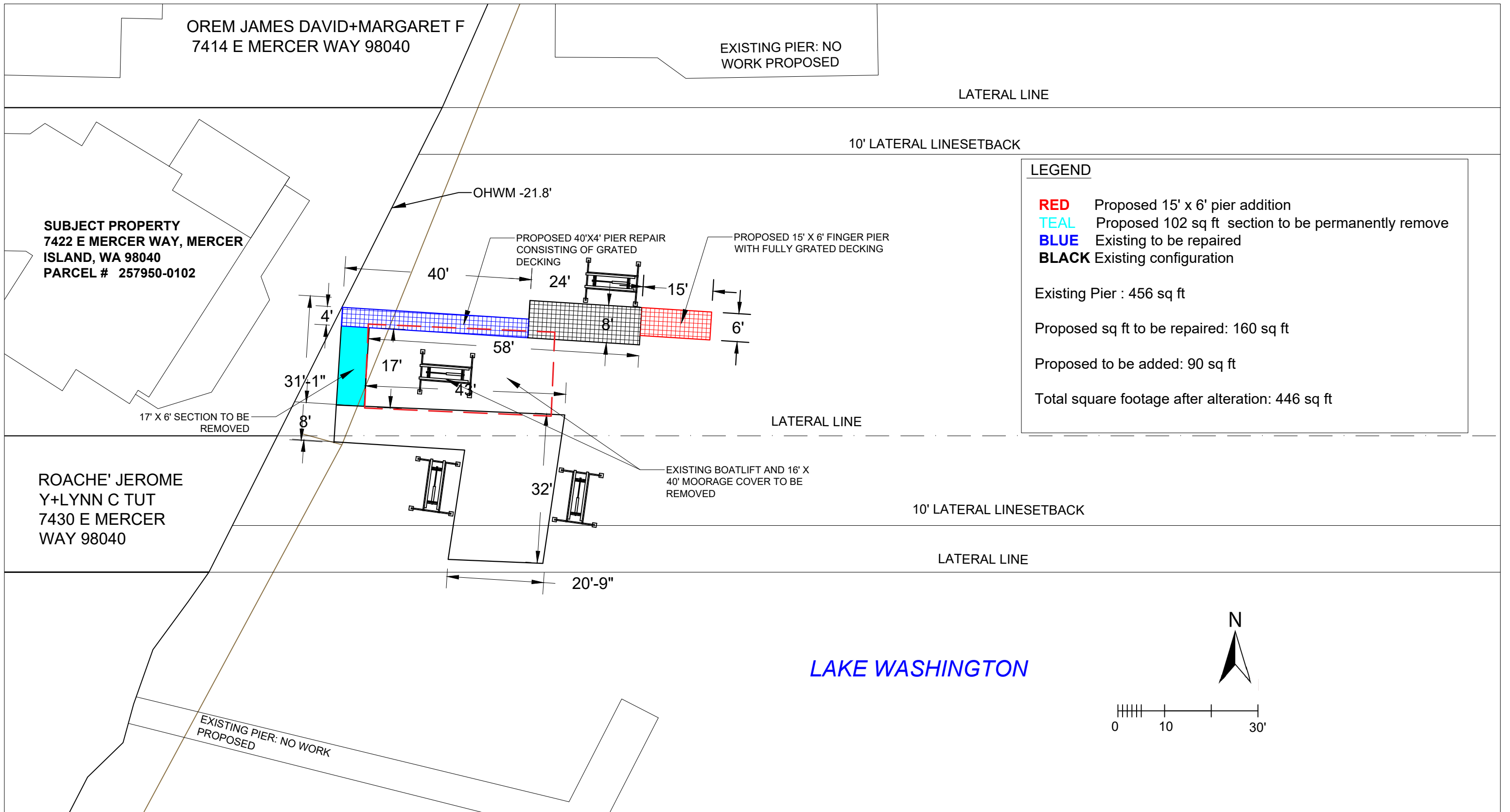

LEGEND

- RED** Proposed 15' x 6' pier addition
- TEAL** Proposed 102 sq ft section to be permanently remove
- BLUE** Existing to be repaired
- BLACK** Existing configuration

Existing Pier : 456 sq ft

Proposed sq ft to be repaired: 160 sq ft

Proposed to be added: 90 sq ft

Total square footage after alteration: 446 sq ft

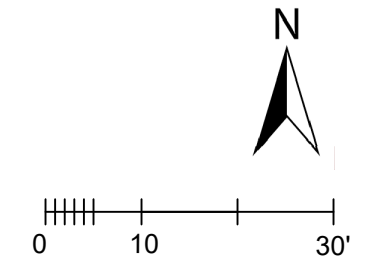

PURPOSE: The proposed repair and extension of the pier is to provide for safe boat moorage for the owner's personal boat.

DATUM: CORPS OF ENGINEERS 1919
SW QUARTER OF SECTION 14, TOWNSHIP 25, RANGE 04

ADJACENT OWNERS:
OREM JAMES DAVID+MARGARET F ROACHE' JEROME Y+LYNN C TUT
Address: 7414 E MERCER WAY 98040 Address: 7430 E MERCER WAY 98040

PREPARED BY: 
JACOB BAWDEN OF SEABORN PILE DRIVING
9311 SE 36TH ST, SUITE 204
MERCER ISLAND, WA 98040
OFFICE: 206-236-1700
JACOB@SEABORNPILEDIVING.COM
WWW.SEABORNPILEDIVING.COM

PROPOSED: Normal repair to an existing shared pier, consisting of permanently removing 720 sq ft moorage cover, remove the inshore 17' x 6' pier section and (13) associated piles, drive (9) wood piles and reconstruct the 40' x 4' pier entrance and a 15' x 6' finger pier extension

IN: LAKE WASHINGTON
AT: 7422 E. Mercer Way
COUNTY: KING
47.5360 N. lat -122.2124 W. Long
CREATED: 5/13/2019

APPLICANT: DUSTIN HOWEL
SEABORN PILE DRIVING COMPANY
9311 SE 36th ST, SUITE 204
MERCER ISLAND, WA 98040

SHEET A2.0

PIER DETAILS

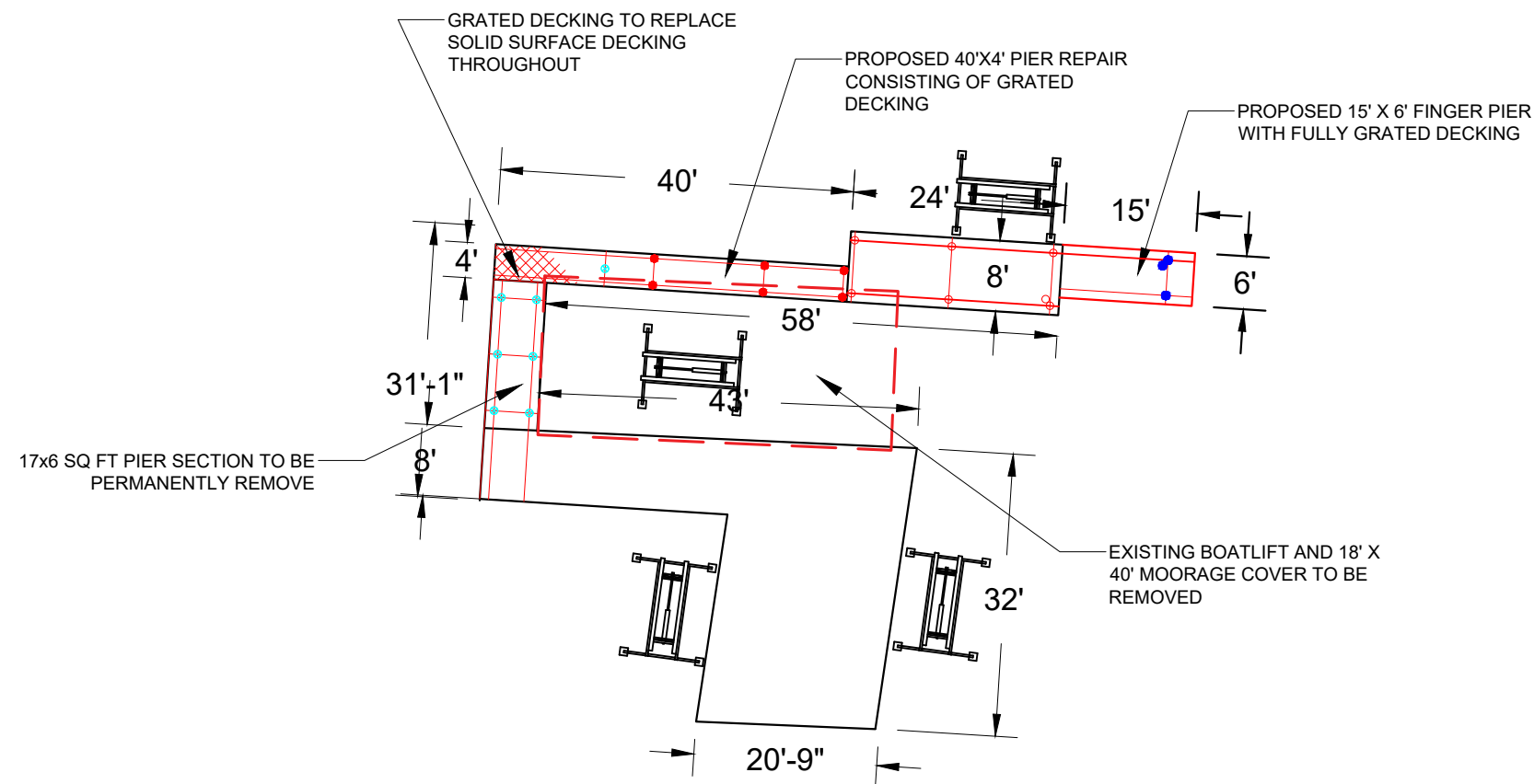

LEGEND

- **RED** Proposed reconfigurations
- **BLACK** Existing configuration
- (6) EXISTING PILES AND (1) BRACE PILE - NO WORK
- (6) EXISTING PILES - TO BE REPLACED
- (2) PROPOSED PILES AND (1) BRACE PILE - TO BE ADDED
- ⊗ (7) EXISTING PILES - TO BE REMOVED

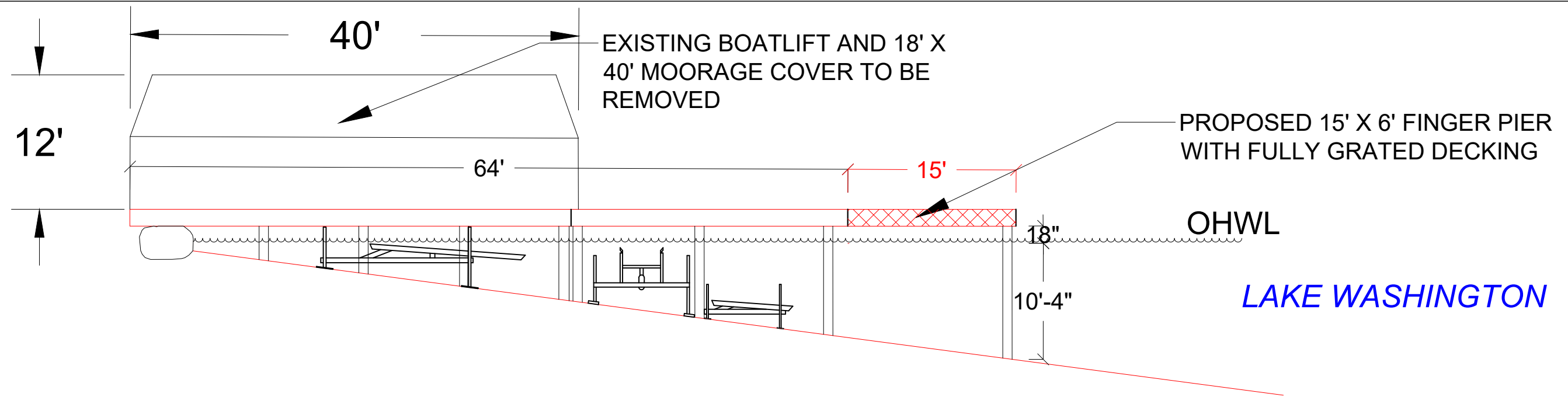

PURPOSE: The proposed repair and extension of the pier is to provide for safe boat moorage for the owner's personal boat.



PREPARED BY:
 JACOB BAWDEN OF SEABORN PILE
 DRIVING 9311 SE 36TH ST, SUITE 204
 MERCER ISLAND, WA 98040
 OFFICE: 206-236-1700
 JACOB@SEABORNPiledriving.com
 WWW.SEABORNPiledriving.com

PROPOSED: Normal repair to an existing shared pier, consisting of permanently removing 720 sq ft moorage cover, remove the inshore 17' x 6' pier section and (13) associated piles, drive (9) wood piles and reconstruct the 40' x 4' pier entrance and a 15' x 6' finger pier extension

DATUM: CORPS OF ENGINEERS 1919
 SW QUARTER OF SECTION 14, TOWNSHIP 25, RANGE 04
 ADJACENT OWNERS:

OREM JAMES DAVID+MARGARET F ROACHE' JEROME Y+LYNN C TUT
 Address: 7414 E MERCER WAY 98040 Address: 7430 E MERCER WAY 98040

IN: LAKE WASHINGTON
 AT: 7422 E. Mercer Way
 COUNTY: KING
 47.5360 N. lat -122.2124 W. Long
 CREATED: 5/13/2019

APPLICANT: DUSTIN HOWEL
 SEABORN PILE DRIVING COMPANY
 9311 SE 36th ST, SUITE 204
 MERCER ISLAND, WA 98040

**SHEET
 A3.0**

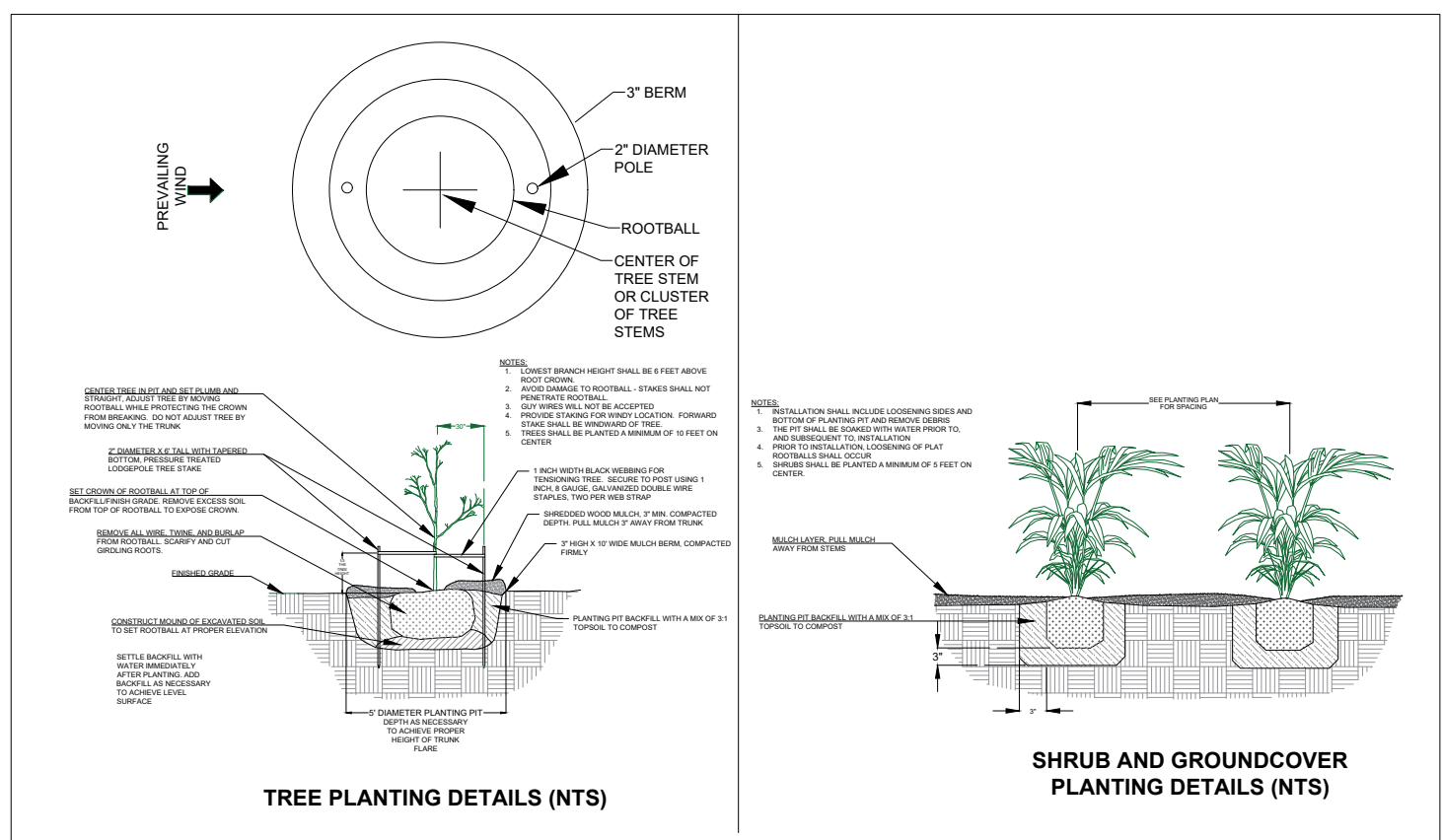
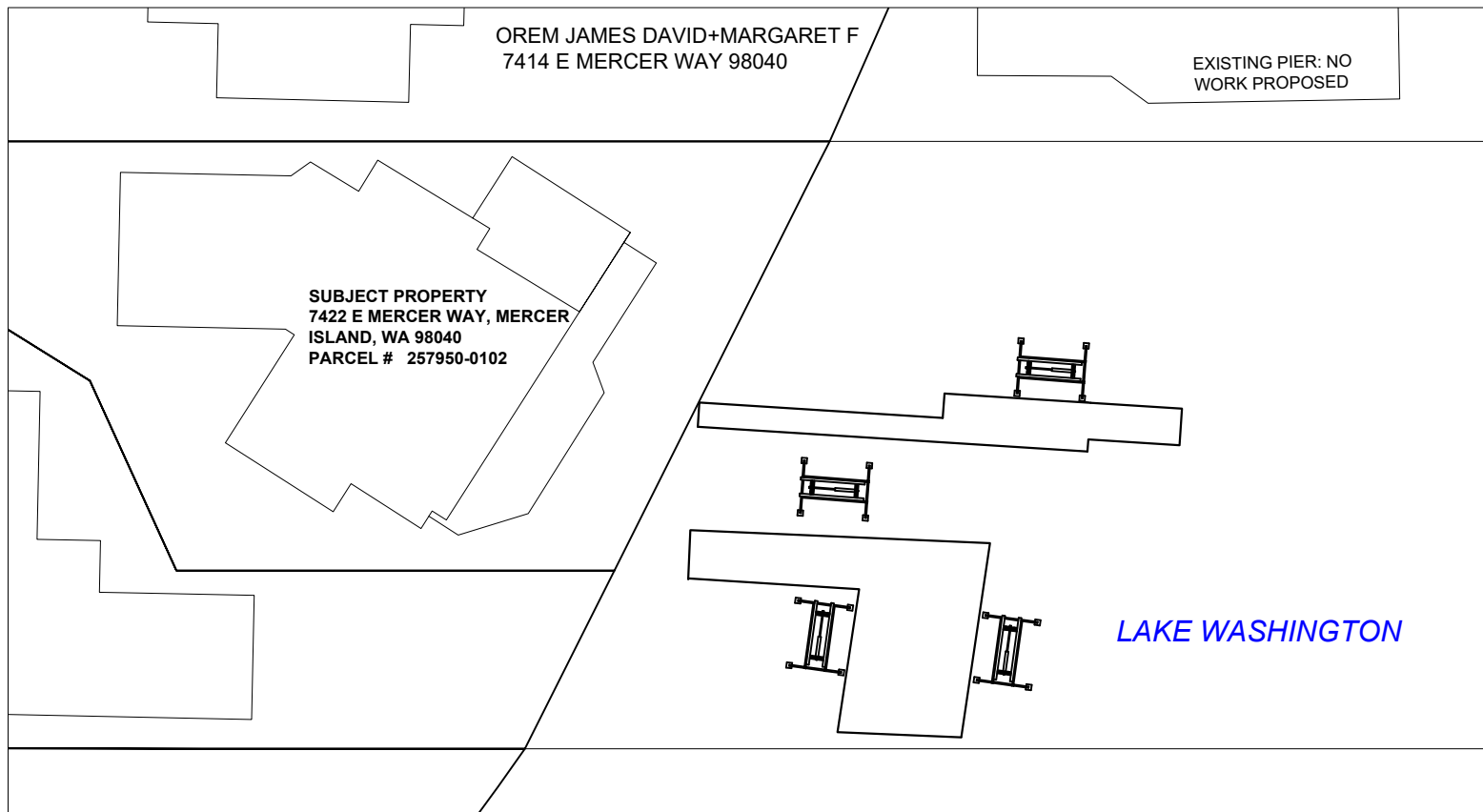

1. Shrubs are show, and shall be planted, at least five feet on center. Trees are show, and shall be planted, at least ten feet on center.
2. The property owner will implement and abide by the shoreline planting plan. The plants shall be installed before or concurrent with the work authorized by this permit. A report, as-built drawing and photographs demonstrating the plants have been installed or a report on the status of project construction will be submitted to the U.S. Army Corps of Engineers, Seattle District, Regulatory Branch, within 12 months from the date of permit issuance. This reporting requirement may be met by completing and submitting a U.S. Army Corps of Engineers approved Report for Mitigation Work Completion form.
3. The property owner will maintain and monitor the survival of installed shoreline plantings for five years after the U.S. Army Corps of Engineers accepts the as-built report. Installed plants shall achieve 100% survival during monitoring Years 1 and 2. Installed plants shall achieve at least 80% survival during monitoring Years 3, 4 and 5. Percent survival is based on the total number of plants installed in accordance with the approved riparian planting plan. Individual plants that die will be replaced with native riparian species in order to meet the survival performance standards.
4. The property owner will provide annual monitoring reports for five years (Monitoring Years 1-5). Each annual monitoring report will include written and photographic documentation on plant mortality and replanting efforts and will document whether the performance standards are being met. Photos will be taken from established points and used repeatedly for each monitoring year. In addition to photos at designated points, photo documentation will include a panoramic view of the entire planting area. Submitted photos will be formatted on standard 8 1/2 x 11" paper, dated with the date the photo was taken, and clearly labeled with the direction from which the photo was taken. The photo location points will be identified on an appropriate drawing. Annual shoreline planting monitoring reports will be submitted to the U.S. Army Corps of Engineers, Seattle District, Regulatory Branch, by November 31 of each monitoring year. This reporting requirement may be met by completing and submitting a U.S. Army Corps of Engineers approved Mitigation Planting Monitoring Report form.

PROPOSED PLANTING SPECIES/QUANTITIES

SYMBOL	LATIN NAME	COMMON NAME	QTY	SIZE
	Thuja picatta	Western Redcedar	2	3 ft
	Rosa nutkana	Nootka Rose	1	1 Gallon
	Philadelphus lewisii	Mock Orange	2	1 Gallon

PURPOSE: The proposed repair and extension of the pier is to provide for safe boat moorage for the owner's personal boat.	 PREPARED BY: JACOB BAWDEN OF SEABORN PILE DRIVING 9311 SE 36TH ST, SUITE 204 MERCER ISLAND, WA 98040 OFFICE: 206-236-1700 JACOB@SEABORNPILEDIVING.COM WWW.SEABORNPILEDIVING.COM	PROPOSED: Normal repair to an existing shared pier, consisting of permanently removing 720 sq ft moorage cover, remove the inshore 17' x 6' pier section and (13) associated piles, drive (9) wood piles and reconstruct the 40'x 4' pier entrance and a 15' x 6' finger pier extension
DATUM: CORPS OF ENGINEERS 1919 SW QUARTER OF SECTION 14, TOWNSHIP 25, RANGE 04 ADJACENT OWNERS: OREM JAMES DAVID+MARGARET F ROACHE' JEROME Y+LYNN C TUT Address: 7414 E MERCER WAY 98040 Address: 7430 E MERCER WAY 98040	IN: LAKE WASHINGTON AT: 7422 E. Mercer Way COUNTY: KING 47.5360 N. lat -122.2124 W. Long CREATED: 5/13/2019	APPLICANT: DUSTIN HOWEL SEABORN PILE DRIVING COMPANY 9311 SE 36th ST, SUITE 204 MERCER ISLAND, WA 98040
		SHEET A4.0

BMP DETAILS

- A. Constant vigilance shall be kept for the presence of protected fish species during all aspects of the proposed action, particularly during in-water activities such as vessel movement, deployment of anchors & spuds, pile driving, dredging, and placement of gravels and other fill.
1. The project manager shall designate an appropriate number of competent observers to survey the project site and adjacent areas for protected species, including the presence of fish as conditions allow.
 2. Visual surveys shall be made prior to the start of work each day, and prior to resumption of work following any break of more than an hour. Periodic additional visual surveys throughout the work day are strongly recommended.
 3. All in-water work shall be done during the in-water work window for the waterbody. Where there is a difference between the USCOE and WDFW work windows, the overlap of the two shall apply.
 4. All pile driving and extraction shall be postponed or halted when obvious aggregations or schooling of fish are observed within 50 yards of that work, and shall only begin/resume after the animals have voluntarily departed the area.
 5. When piloting vessels, vessel operators shall operate at speeds and power settings to avoid grounding vessels, and minimize substrate scour and mobilization of bottom sediments.
- B. No contamination of the marine environment shall result from project-related activities.
1. Appropriate materials to contain and clean potential spills shall be stored and readily available at the work site and/or aboard project-related vessels.
 2. The project manager and heavy equipment operators shall perform daily pre-work equipment inspections for cleanliness and leaks. All heavy equipment operations shall be postponed or halted should a leak be detected, and shall not proceed until the leak is repaired and the equipment is cleaned.
 3. To the greatest extent practicable, utilize biodegradable oils for equipment that would be operated in or near water.
 4. Fueling of land-based vehicles and equipment shall take place at least 50 feet away from the water, preferably over an impervious surface. Fueling of vessels shall be done at approved fueling facilities.
 5. Turbidity and siltation from project-related work shall be minimized and contained through the appropriate use of erosion control practices, effective silt containment devices, and the curtailment of work during adverse weather and tidal/flow conditions.
 6. All wastes shall be collected and contained for proper disposal at approved upland disposal sites appropriate for the material(s).
 7. When removing piles and other similarly treated wood, containment booms must fully enclose the work area. Wood debris, oils, and any other materials released into lake waters must be collected, removed, and properly disposed of at approved disposal sites.
 8. All in- and over-water wood cutting would be limited to the minimum required to remove the subject wood component, and all cutting work should be enclosed within floating containment booms.
 9. When removing piles, no actions shall be taken that would cause adhering sediments to return to lake waters.
 10. Above-water containment shall be installed around removed piles to prevent sediment laden waters from returning to lake waters.
 11. Construction staging (including stocking of materials, etc.) will occur on the supply barge.

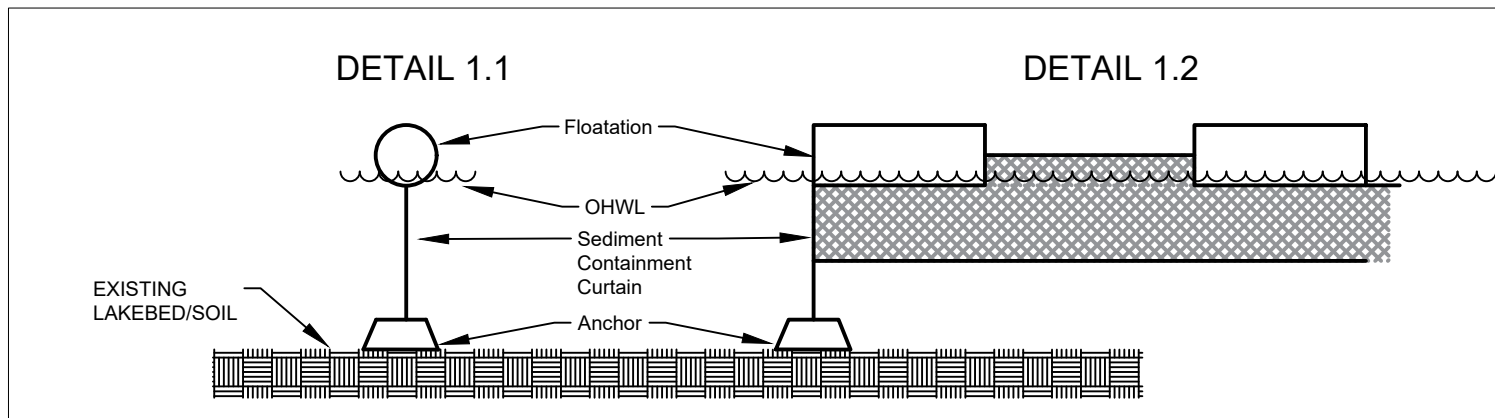
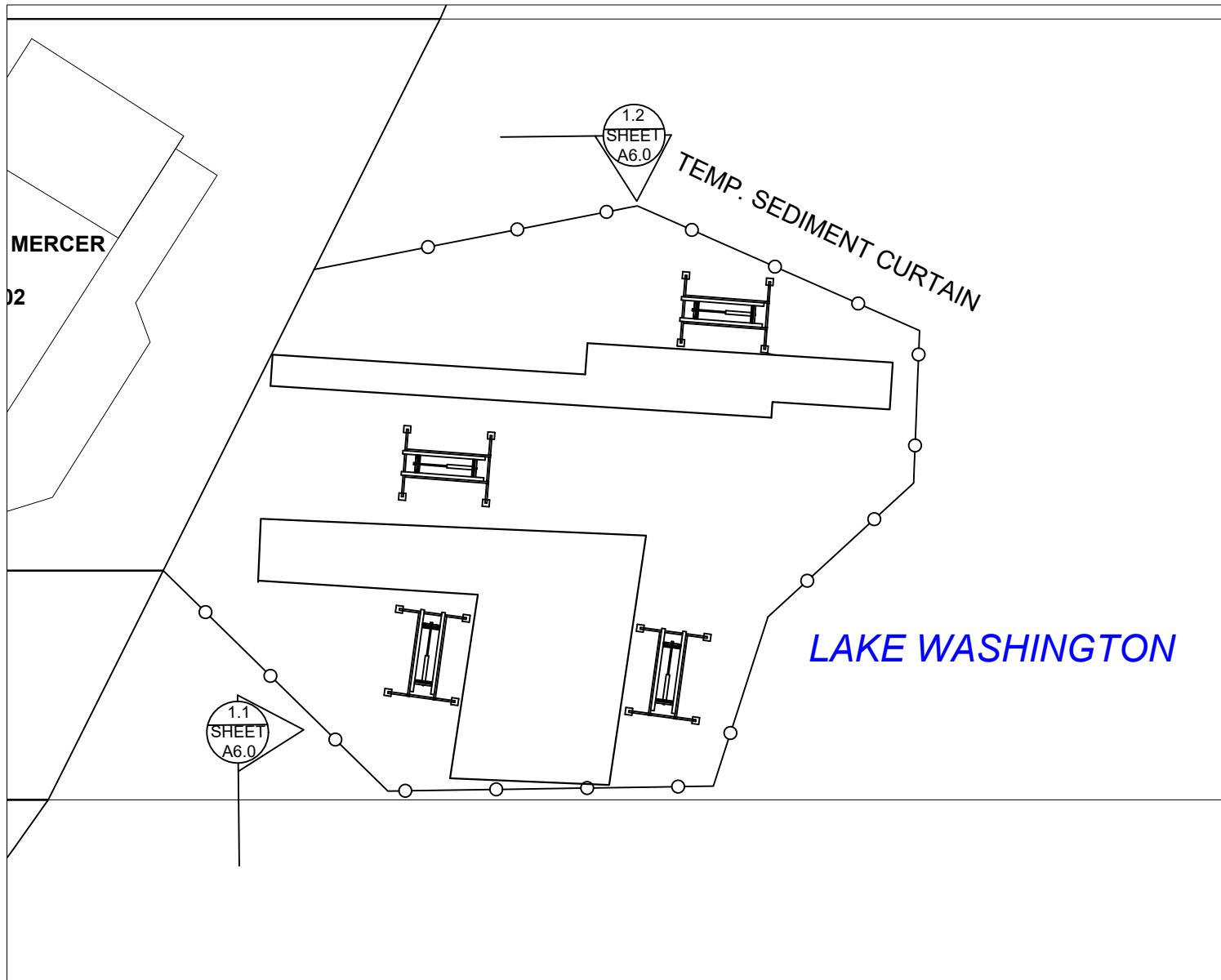

<p>PURPOSE: The proposed repair and extension of the pier is to provide for safe boat moorage for the owner's personal boat.</p>	<p>PREPARED BY:  JACOB BAWDEN OF SEABORN PILE DRIVING 9311 SE 36TH ST, SUITE 204 MERCER ISLAND, WA 98040 OFFICE: 206-236-1700 JACOB@SEABORNPILEDIVING.COM WWW.SEABORNPILEDIVING.COM</p>	<p>PROPOSED: Normal repair to an existing shared pier, consisting of permanently removing 720 sq ft moorage cover, remove the inshore 17' x 6' pier section and (13) associated piles, drive (9) wood piles and reconstruct the 40'x 4' pier entrance and a 15' x 6' finger pier extension</p>
<p>DATUM: CORPS OF ENGINEERS 1919 SW QUARTER OF SECTION 14, TOWNSHIP 25, RANGE 04 ADJACENT OWNERS: OREM JAMES DAVID+MARGARET F ROACHE' JEROME Y+LYNN C TUT Address: 7414 E MERCER WAY 98040 Address: 7430 E MERCER WAY 98040</p>	<p>IN: LAKE WASHINGTON AT: 7422 E. Mercer Way COUNTY: KING 47.5360 N. lat -122.2124 W. Long CREATED: 5/13/2019</p>	<p>APPLICANT: DUSTIN HOWEL SEABORN PILE DRIVING COMPANY 9311 SE 36th ST, SUITE 204 MERCER ISLAND, WA 98040</p>